



**SKU Builder**

**DI** - **24V** - **FV** - **90**

Diode - Voltage - Model - Color Temp - CRI - Length

20	35	16	(16 feet)
24	38	100	(100 feet)
27	42	400	(400 feet)
28	44	CSTM <sup>1</sup> (length)	
30	50		
33	63		

Example: DI-24V-FV40-9033 = Diode, 24 Volt, FLUID VIEW™, 4,000° CCT, 90 CRI, 33 foot spool.

FLUID VIEW™	
<b>Voltage/Wattage</b>	24v / 1.44W/ft.
<b>Lumens<sup>2</sup> &amp; CRI</b>	<b>2000K</b> 87 Lm/ft. / 92 CRI
	<b>2400K</b> 90 Lm/ft. / 96 CRI
	<b>2700K</b> 99 Lm/ft. / 93 CRI
	<b>2850K</b> 106 Lm/ft. / 92 CRI
	<b>3000K</b> 104 Lm/ft. / 94 CRI
	<b>3300K</b> 105 Lm/ft. / 94 CRI
	<b>3500K</b> 106 Lm/ft. / 93 CRI
	<b>3800K</b> 114 Lm/ft. / 93 CRI
	<b>4200K</b> 114 Lm/ft. / 92 CRI
	<b>4400K</b> 117 Lm/ft. / 92 CRI
	<b>5000K</b> 116 Lm/ft. / 93 CRI
<b>6300K</b> 115 Lm/ft. / 94 CRI	
<b>Max. Run<sup>3</sup></b>	67 feet
<b>Field Cuttable</b>	~4 in. (100mm)
<b>LED Chips</b>	18/foot
<b>Dimmable</b>	Yes
<b>Dimensions</b>	0.31 x 0.1 in. (W x H)
<b>Environment<sup>4</sup></b>	Indoor / Dry Location
<b>Certification</b>	UL Listed 2108
<b>Warranty</b>	12-Year Warranty

## FEATURES

- Accent or ambient lighting
- Class 2 linear runs up to 67ft.
- 90+ CRI
- Cuttable every 4 inches
- 3M™ 55280 Adhesive backing

Item # \_\_\_\_\_

Project \_\_\_\_\_

© 2017 Elemental LED, Inc. All rights reserved. Specifications are subject to change without notice.

Toll Free: 877.817.6028 | Fax: 415.592.1596 | [www.DiodeLED.com](http://www.DiodeLED.com) | [info@DiodeLED.com](mailto:info@DiodeLED.com)

# FLUID VIEW™ 24V LED Tape Light

SPECIFICATION SHEET

## SPECIFICATIONS

- Power Consumption / ft.: 1.44W / 60mA
- LED Chip Type: Epistar 3528 SMD Chip
- LED Chip Beam Angle: 120°
- Luminous Efficacy<sup>4</sup> (lm/w): 60~81
- Mounting<sup>5</sup>: 3M™ 55280 Adhesive
- Field Cuttable: ~ 4 in. (100mm)
- Connections<sup>7</sup>: 3 ft. Female DC plug on end. 3 ft. hard-wire lead opposing end. Leads: UL 2464 20/2 AWG
- Ambient Temp<sup>8</sup>: -4 ~ 122°F (-20 ~ 50°C)
- Operating Temp<sup>9</sup>: -4 ~ 176°F (-20 ~ 80°C)

## COMPATIBLE DRIVERS

Additional information on compatible Drivers can be found on page 4-5 or on the Diode LED web site at: [www.DiodeLED.com](http://www.DiodeLED.com).

## COMPLIANCE & REGULATORY APPROVALS

### Safety

- UL Listed 2108 Low Voltage Lighting System / Low Voltage Luminaire. UL 1598 / CSA 250.0-08, UL 8750. UL 879 / CAN/CSA-C22.2 no. 207-M89. Certified for United States and Canada. File # E469769.
- UL Listed Field Cuttable.
- UL Recognized Component - Sign Accessories. Available in UL Sign Components Manual (SAMS Manual). File # E469770.

### Performance

- LED chip data measured in accordance to IES LM-80-08.
- Photometric & Colorimetry data measured in accordance to IES LM-79-08, in Elemental LED's Innovation Lab.

1. Requests for custom lengths of Strip Light will be cut to the nearest (lower) cut point. (example: DI-24V-FV30-90CSTM-15' 3" would be cut to 180 inches (ie. 15' 0"))
2. Epistar 3528 SMD Chip binning ranges: (2400K 90+ CRI: 2300-2425K), (2700K 90+ CRI: 2580-2725K), (2850K 90+ CRI: 2725-2870K), (3000K 90+ CRI: 2870-3045K), (3300K 90+ CRI: 3220-3465K), (3500K 90+ CRI: 3465-3710K), (3800K 90+ CRI: 3710-3985K), (4200K 90+ CRI: 3985-4260K), (4400K 90+ CRI: 4260-4503K), (5000K 90+ CRI: 4745-5028K), (6300K 90+ CRI: 6020-6530K).
3. Each maximum run requires a dedicated power feed from the driver. Do not extend beyond the recommended maximum run length.
4. Actual efficacy value is dependent to specified LED driver (power supply). An estimated efficacy value can be calculated as follows: Lumen value divided by average power consumption per foot.
5. Do not install in environment where LED chips are exposed to direct sunlight as damage to the phosphor will occur.
6. Ideal tape application temperature range is 70°F to 100°F (21°C to 38°C). Initial tape application to surfaces at temperatures below 50°F (10°C) is not recommended because the adhesive becomes too firm to adhere readily. However, once properly applied, low temperature holding is generally satisfactory.
7. Wire leads and accessories are not rated for in-wall installation unless otherwise noted. Attached wire leads and connections are field-cuttable.
8. Do not install product in an environment outside the listed ambient temperature. Exceeding the maximum ambient temperature may damage LED chips, reduce the total lamp life, lumen output, and/or adversely impact color consistency.
9. Operating temperature is measured according to the minimum and maximum ambient temperature environment.

# FLUID VIEW™ 24V LED Tape Light

SPECIFICATION SHEET

## ADDITIONAL ACCESSORIES

Accessories listed below fully support our Tape Light product line. Further information on these products and more accessories can be found in our latest catalog or online at [www.DiodeLED.com](http://www.DiodeLED.com).

TERMINAL BLOCK CONNECTOR  
Tape Light Connector

**DI-TB-CONN-TTW**

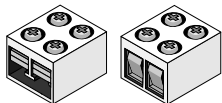

CLICKTIGHT®  
Tape Light Connectors

**DI-CKT**

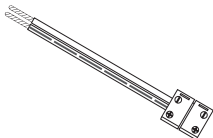

TAPEGUARD®  
LED Light Cover

**DI-TAPE-GRD**

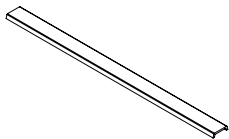

CHROMAPATH®  
Aluminum Channels

**DI-CPCHA**

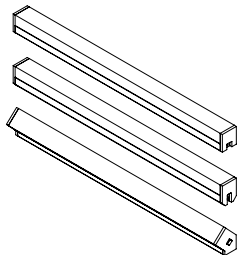

CHROMAPATH® SLIM  
Recessed Channels

**DI-CPCHA**

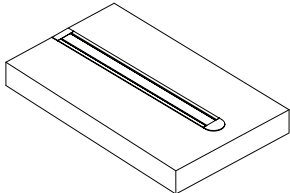



# FLUID VIEW™ 24V LED Tape Light

SPECIFICATION SHEET

## LED DRIVERS (Required)

The following Listed LED Drivers are recommended for compatibility and to meet NEC code when installed according to specifications. For additional LED Driver options see Diode LED's product page at: <https://www.diodeled.com/products/led-power-supplies.html>

### SWITCHEX® DRIVER + DIMMER SWITCH

SWITCHEX combines an LED driver and LED dimmer switch into a single integrated unit. Fits into standard switch boxes.



SKU	L - LENGTH	W - WIDTH	H - HEIGHT
DI-24V-SE-60W	1.40 in.	2.10 in.	4.10 in.
DI-24V-SE-100W	1.40 in.	2.10 in.	4.10 in.

Fits in Standard Switch Box

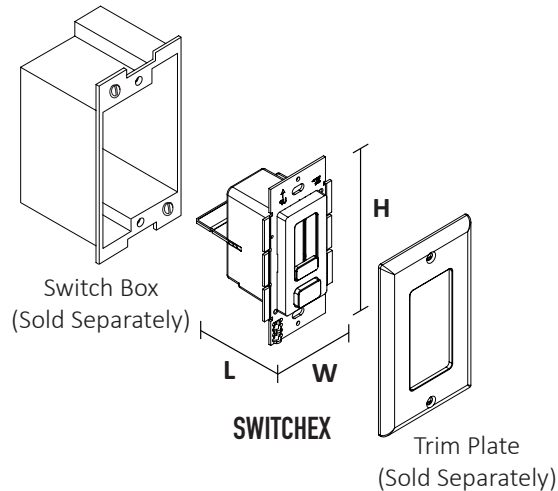

### LO-PRO® JUNCTION BOX & DRIVER COMBO - 24V CONSTANT VOLTAGE LED DRIVER

Use Constant Voltage Drivers to power your lighting system. Compatible with Standard 120VAC On/Off Switches, REIGN® Low Voltage Dimmers, TOUCHDIAL™ Control System, DMX Decoders, and PWM Controls.

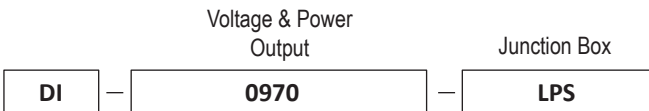

SKU	L - LENGTH	W - WIDTH	H - HEIGHT
DI-0970-LPS	11.25 in.	3.75 in.	1.90 in.
DI-CV-MW24V60W-277-LPS	11.25 in.	3.75 in.	1.90 in.
DI-CV-MW24V90W-277-LPS	11.25 in.	3.75 in.	1.90 in.
DI-0954-LPL	13.5 in.	4.5 in.	2.37 in.

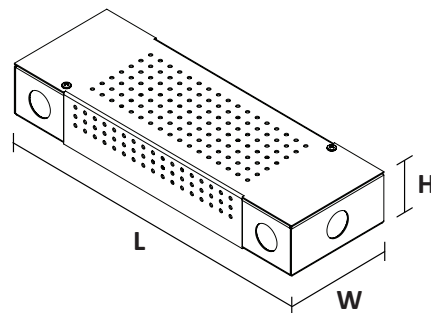

### LO-PRO® JUNCTION BOX & DRIVER COMBO - 24V COMMERCIAL GRADE 0-10V LED DIMMABLE DRIVER

Compatible with 0-10V controls and dimming systems.

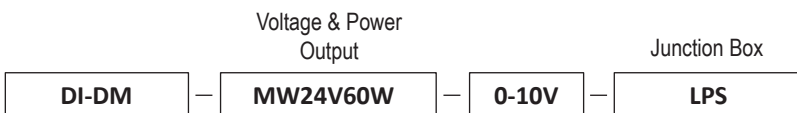

SKU	L - LENGTH	W - WIDTH	H - HEIGHT
DI-DM-MW24V60W-0-10V-LPS	11.25 in.	3.75 in.	1.90 in.
DI-DM-MW24V90W-0-10V-LPL	13.5 in.	4.5 in.	2.37 in.

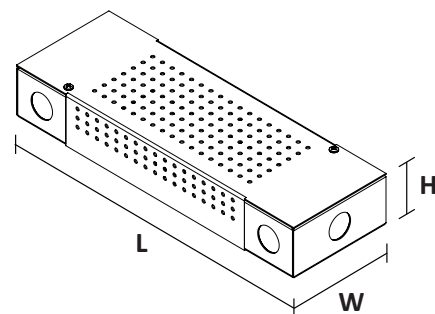

# FLUID VIEW™ 24V LED Tape Light

SPECIFICATION SHEET

## LED DRIVERS Cont. (Required)

The following Listed LED Drivers are recommended for compatibility and to meet NEC code when installed according to specifications. For additional LED Driver options see Diode LED's product page at: <https://www.diodeled.com/products/led-power-supplies.html>

### OMNIDRIVE® 2 ELECTRONIC DIMMABLE LED DRIVER

OMNIDRIVE 2 features a zero minimum load and 100-5% dimming range. Compatible with Forward Phase and Reverse Phase Dimmers. Please see Diode LED's Compatibility List at: <https://www.diodeled.com/custom/download/productFile/filename/DI-OD2-Compatibility%20List.pdf>

		Voltage & Power Output
DI	OD2	24V24W

SKU	L - LENGTH	W - WIDTH	H - HEIGHT
DI-OD2-24V24W	13.75 in.	3.00 in.	1.60 in.
DI-OD2-24V60W	13.75 in.	3.00 in.	1.60 in.
DI-OD2-24V96W	15.00 in.	3.10 in.	2.40 in.
DI-OD2-24V120W	15.00 in.	3.10 in.	2.40 in.
DI-OD2-24V200W	16.10 in.	3.40 in.	2.40 in.

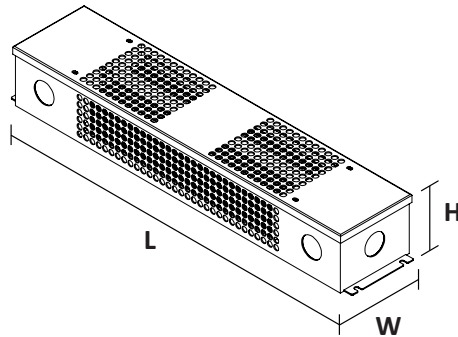

### LUTRON® Hi-lume 1% LED DIMMABLE DRIVER

Hi-lume 1% LED Driver has a minimum load of 5W and dims from 100-1%.

	Voltage & Power Output	3-Wire or 2-Wire Dimmers
DI-DM	24V40W	L3D

SKU	L - LENGTH	W - WIDTH	H - HEIGHT
DI-DM-24V40W-L3D	4.89 in.	4.00 in.	2.62 in.
DI-DM-24V40W-LTE			

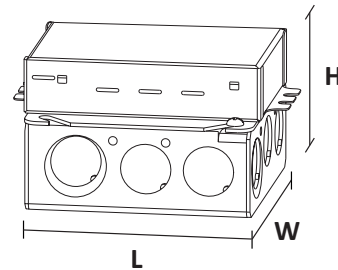

### LUTRON® Hi-lume Premier 0.1% LED DIMMABLE DRIVER

Hi-Lume Premier 0.1% LED Driver has a minimum load of 5W and dims from 100-0.1%.

	Voltage & Power Output	
DI-DM	24V96W	L3D

SKU	L - LENGTH	W - WIDTH	H - HEIGHT
DI-DM-24V96W-L3D	5.50 in.	2.20 in.	10.50 in.

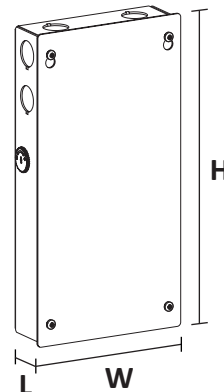

# FLUID VIEW™ 24V LED Tape Light

SPECIFICATION SHEET

## ADDITIONAL INFORMATION

- LOW VOLTAGE LED TAPE LIGHT Installation Guide

## SAFETY / WARNINGS / DISCLOSURES

1. Install in accordance with national and local electrical code regulations.
2. This product is intended to be installed and serviced by a qualified, licensed electrician.
3. Only install with a Class 2 DC Constant Voltage LED driver. This product has not been evaluated for use when connected to an LED driver that does not comply with Class 2 voltage and energy limited supplies.
4. Only use copper wiring. Use wires rated for at least 176°F (80°C) and certified for use with external connection of electrical equipment.
5. Each maximum run requires a dedicated power feed from the driver. Do not extend beyond the recommended maximum run length.
6. Tape light, attached wire leads, and additional extension cables, connectors, etc., are not rated for in-wall installation unless otherwise noted. Tape light and attached wire leads are field-cuttable.
7. Ensure applicable wire is installed between driver, fixture, and any controls in-between. When choosing wire, factor in voltage drop, amperage rating, and type (in-wall rated, wet location rated, etc.). Inadequate wire installation could overheat wires, and cause fire.
8. Do not install in environment where LED chips are exposed to direct sunlight as damage to the phosphor will occur.
9. Do not install in environment where excessive heat may exist (ex. close proximity to fireplace, etc.) See Ambient Temperature ratings
10. Do not install indoor LED tape light products in outdoor / wet location environments. Only wet location tape light models are rated for outdoor / wet locations.
11. Do not modify product beyond instructions or warranty will be void.
12. Tape light must be handled with care. Excessive handling, bending, and pressure may damage the product, voiding the warranty.
13. Actual color may vary from what is pictured on this sheet and other print materials due to the limitations of photographic processes.
14. We reserve the right to modify and improve the design of our fixtures without prior notice. We cannot guarantee to match existing installed fixtures for subsequent orders or replacements in regards to product appearance, CCT, or lumen output.

## WARRANTY

### Limited Warranty

This product has a twelve (12) year limited warranty from the date of shipment. This warranty does not include the additional accessories referenced in this specification sheet. Complete warranty details for fixtures and additional accessories are available at [www.diodeled.com/limited-warranty/](http://www.diodeled.com/limited-warranty/) within the Policies section. For warranty related questions please contact product support.

### Consumer's Acknowledgment

Elemental LED, Inc. stands behind its products when they are used properly and according to our specifications. By purchasing our products, the purchaser agrees and acknowledges that lighting design, configuration and installation is a complex process, wherein seemingly minor factors or changes in layout and infield adjustments can have a significant impact on an entire system. Choosing the correct components is essential. Elemental LED is able to work with the original purchaser to make an appropriate product selection to the extent of the limited information that the customer can provide, but it is virtually impossible for Elemental LED to design a system that foresees every unknown factor. For this reason, this Warranty does not cover problems caused by improper design, configuration or installation issues. Any statement from an Elemental LED employee or agent regarding a customer's bill of goods and/or purchase order is NOT an acknowledgment that the products purchased are designed and configured correctly. The purchaser agrees and acknowledges that it is the customer's responsibility to adhere strictly to all information contained in the Product Specification Sheets.

There is often more than one way to design, configure and layout an LED lighting application properly to achieve the same lighting effect. Elemental LED strongly recommends that licensed professionals be used in the design and installation of lighting systems that include Elemental LED products. The specifications include important information that a designer and installer should carefully review and strictly follow. Qualified designers and certified and/or licensed installers, with access to the final installation environment, customer goals, and Elemental LED product specifications can make the requisite decisions appropriate for a successful finished lighting application.



© 2017 Elemental LED, Inc. All rights reserved.  
Specifications are subject to change without notice.

Toll Free: 877.817.6028 | Fax: 415.592.1596 | [www.DiodeLED.com](http://www.DiodeLED.com) | [info@DiodeLED.com](mailto:info@DiodeLED.com)